

97 mm

San Ace B97

33mm thick (9BM type)
33mm thick (9BMB type)

General Specifications

- Material Frame: Plastics (Flammability: UL94V-0),
Impeller: Plastics (Flammability: UL94V-0)
- Expected Life Refer to specifications (L10:Survival rate: 90% at 60°C ,
rated voltage, and continuously run in a free air state)
- Lead Wire ⊕red ⊖black (Sensor) yellow
- Storage Temperature -30°C to +70°C (Non-condensing)

97 mm × 33 mm (Mass : 175g) **9BM type**

Specifications The following nos. have pulse sensors.

Model No.	Rated Voltage [V]	Operating Voltage Range [V]	Rated Current [A]	Rated Input [W]	Rated Speed [min ⁻¹]	Max. Airflow [m ³ /min] [CFM]	Max. Static Pressure [Pa] [inchH ₂ O]	SPL [dB(A)]	Operating Temperature [°C]	Expected Life ^{Typ} [h]
109BM12GC2-1	12	7 to 13.8	0.60	7.20	3,800	0.82 28.9	281 1.129	51.5	-20 to +70	40,000/60°C (70,000/40°C)
109BM12HC2-1			0.40	4.80	3,300	0.71 25.1	204 0.819	48.5		
109BM12MC2-1			0.26	3.12	2,700	0.58 20.5	119 0.478	43.5		
109BM24GC2-1	24	12 to 27.6	0.31	7.44	3,800	0.82 28.9	281 1.129	51.5		
109BM24HC2-1			0.26	6.24	3,300	0.71 25.1	204 0.819	48.5		
109BM24MC2-1			0.15	3.60	2,700	0.58 20.5	119 0.478	43.5		

Note: Expected life at 40°C ambient is just reference value.

Some models can also be equipped without sensors or with PWM control functions as an option. Please refer to the index (pp. 417 to 437).

Dimensions (unit : mm)

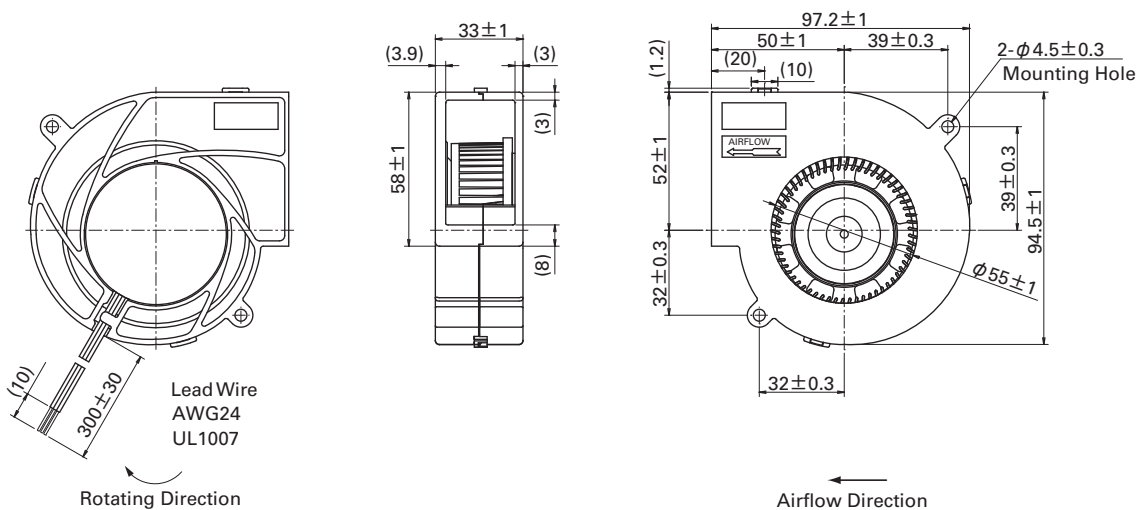

Airflow - Static Pressure Characteristics

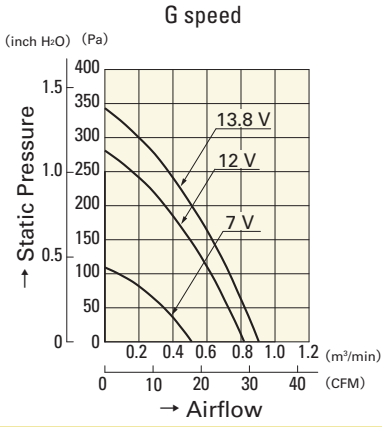

109BM12GC2-1

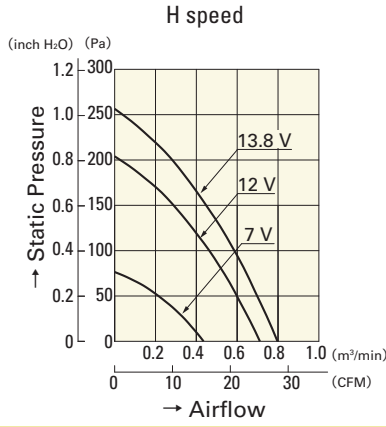

109BM12HC2-1

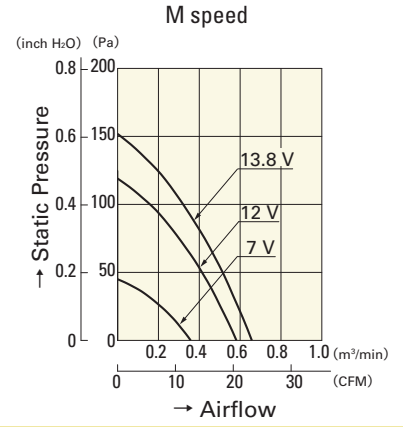

109BM12MC2-1

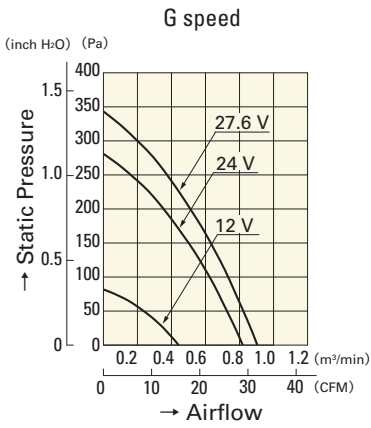

109BM24GC2-1

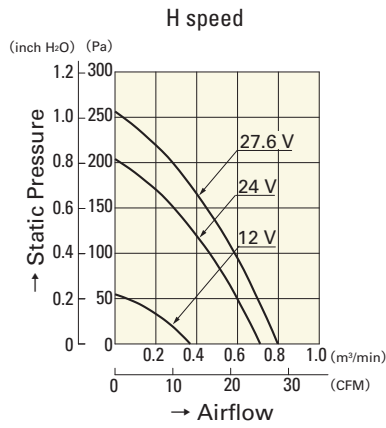

109BM24HC2-1

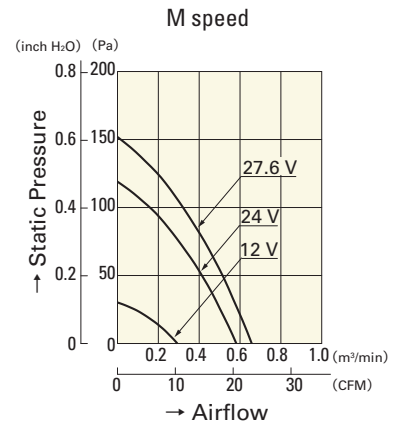

109BM24MC2-1

DC
Blower 97mm